

Technical description

1. Reception panels

Front panel – made of melamine faced chipboard (MFC), class E1, thickness 25 mm with 2 mm edge in glue technology.

Panel shelf, depth 250 mm, made of melamine faced chipboard (MFC), class E1, thickness 18 mm with 2 mm edge in glue technology. Panel can be equipped with upholstered, pinnable pad on the user's side as an option. Pad is made of 8 mm soft fibreboard covered with upholstery. Each panel is pre-drilled for fixing external upholstered pads (to be ordered separately).

Side panel – made of melamine faced chipboard (MFC), class E1, thickness 25 mm with 2 mm edge in glue technology. Each panel is pre-drilled for fixing external upholstered pads (to be ordered separately).

External upholstered pads (set of 3 pieces) – made of chipboard, thickness 18 mm, covered with upholstery, not pinnable. Assembly to panel with quick release fixing, allowing for multiple pads replacement. Gaps between pads with visible panel board – 18 mm.

Front and side panels are assembled directly to desk table top (Easy Space) or to desk frame (SQart), with dedicated metal brackets. Levelling in range of 10 mm.

2. Product range

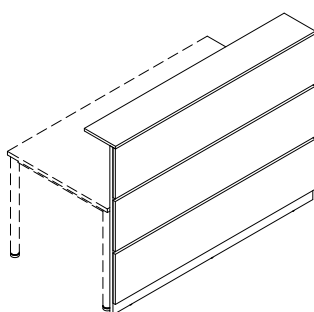

Reception front panel with shelf and upholstered pads

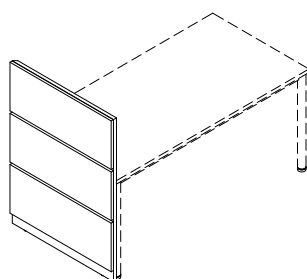

Reception side panel with upholstered pads

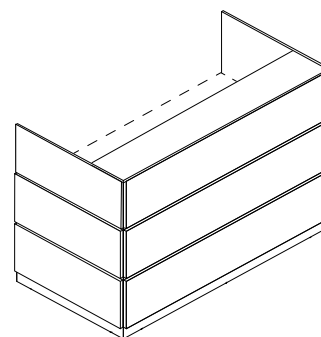

3. Sample order

Product code										Finish code					
Product line	Model	Version	Dimensions		Integration		Upholstery				Panel board	Shelf	Upholstery on user's side		
WNLT	F	L	1	0	I	N	T	N	N		BI	MS	T8	00	00

The following part of code **WNLTFL10INTNN-BIMST80000** identifies product as:

Check-in reception panel with shelf (**WNLT**) front (**F**), for integration with left side panel (**L**), width 1000 mm (**10**), for integration with Easy Space desk (**I**), with upholstered pad on user's side (**T**)

The following part of code **WNLTFL10INTNN-BIMST80000** identifies product finishes as:

Panel board made of melamine faced chipboard (MFC) in white colour (**BI**), panel shelf made of melamine faced chipboard (MFC) in slate colour (**MS**), upholstered pad on user's side in Lucia YB046 fabric (**T8**)

Omega Ekspress SIA

LV40003402577

Biroja adrese: Lāčplēša 125, LV-1003, Rīga

www.city-office.lv

info@city-office.lv